

1-22-10

PROFESSIONAL ENGINEER'S SEAL

HAVEN COMPLEX
BRACKEN STREET AND HORNER BOULEVARD
SANFORD, NORTH CAROLINA

SITE LAYOUT PLAN

BRACKEN ST

NEW BRICK RETAINING WALL - NCDOT STD 842.02 (FLUSH WITH SIDEWALK)

HORNER BLVD

NEW BRICK RETAINING WALL - NCDOT STD 842.02 (FLUSH WITH SIDEWALK)

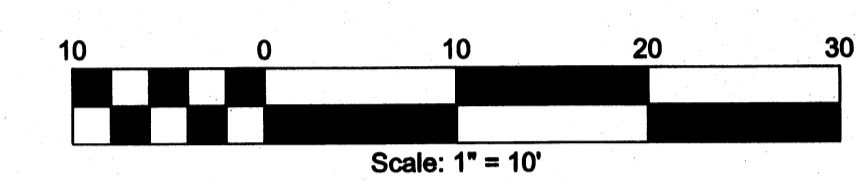
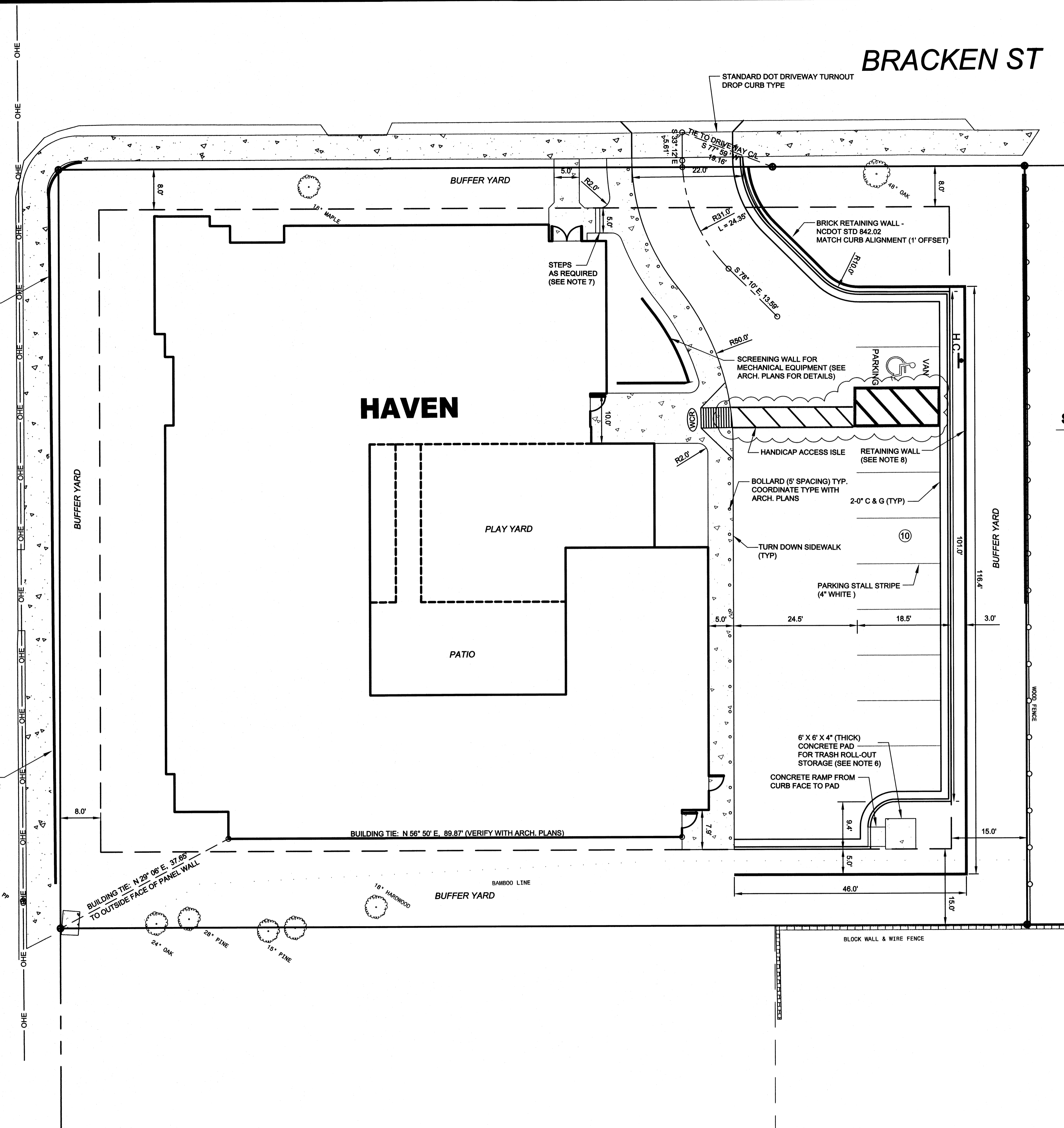

SITE DATA

PROPERTY ID:
LEE COUNTY, NORTH CAROLINA
DEED REFERENCES: D.B. 905 PG. 21
LEE COUNTY PIN #S = 9643-51-1419-00, 9643-51-1421-00, 9643-51-2522-00

SITE INFO:

| | |
|--------------------------------------|---|
| ZONING CLASSIFICATION = | OFFICE & INSTITUTIONAL |
| TOTAL SITE AREA = | 0.661 AC |
| PARKING SPACES REQUIRED = | 13 (1 PER 600 OFFICE SF + 6 ROOMS + 1 FULL TIME EMPLOYEE) |
| PARKING SPACES PROPOSED (INCL. HC) = | 10 ON-SITE, 3 OFF-SITE MIN. (PER AGREEMENT) |
| HANDICAPPED SPACES PROPOSED = | 1 |
| PROPOSED GSF (HEATED) = | 9,039 SF |
| PROPOSED OFFICE GSF = | 3,499 SF |
| INTENDED USE: | HAVEN SHELTER |
| IMPERVIOUS AREA: | 0.42 AC (63% OF SITE) |

NOTES

- REVIEW AND APPROVAL OF THE PLANS DOES NOT RELIEVE THE OWNER, CONTRACTOR, OR DEVELOPER FROM MEETING ALL THE REQUIREMENTS OF THE CITY OF SANFORD UNIFIED DEVELOPMENT ORDINANCE, AND ANY OTHER LOCAL, STATE, AND FEDERAL REGULATIONS AND APPROVALS.
- ALL IMPROVEMENTS OR EXTENSIONS OF PUBLIC INFRASTRUCTURE UNDER THE JURISDICTION OF THE CITY OF SANFORD SHALL BE IN STRICT ACCORDANCE WITH THE ORDINANCES, REGULATIONS, POLICIES, REQUIREMENTS, AND SPECIFICATIONS OF THE CITY OF SANFORD.
- THIS SITE IS NOT WITHIN THE 100 YEAR FLOOD HAZARD BOUNDARY AREAS AS DELINEATED ON THE LEE COUNTY FLOOD INSURANCE MAP (FIRM) MAP NUMBER: 3710964200J, PANEL NUMBER: 9642, REVISED SEPT 6, 2006.
- SIDEWALK THAT ABUTS PAVEMENT IS TO BE THE TURN-DOWN TYPE. SEE DETAILS.
- CONTRACTOR TO VERIFY QUANTITIES SHOWN ON PLANS BASED ON ACTUAL FIELD CONDITIONS.
- CONTRACTOR TO PROVIDE STORAGE FOR TRASH ROLL-OUTS. STORAGE AREA TO BE SCREENED PER SANFORD REQUIREMENTS (SEE ARCHITECTURAL PLANS.)
- HANDRAILS TO BE CONSTRUCTED FOR STEPS - SEE ARCHITECTURAL PLANS FOR DETAILS.
- RETAINING WALL TO BE BRICK RETAINING WALL - NCDOT STANDARD 842.02 (CONCRETE AND BRICK RETAINING WALLS WITH SLOPING SURCHARGE). BRICK FOR WALL TO MATCH TYPE AND COLOR OF BUILDING BRICK.

REVISIONS

22 JAN 10: RELOCATED HANDICAP UNLOADING AREA - ADDED ACCESS ISLE FROM UNLOADING AREA TO SIDEWALK RAMP

ISSUED FOR CONSTRUCTION

| | |
|---------------------------|---------------------|
| Scale: 1" = 10' | Drawn by: JRT |
| Sheet: C3 of 9 | Designed by: JRT |
| Project Number: 09-015 | Reviewed by: JRT |
| | Date: DEC 2009 |